

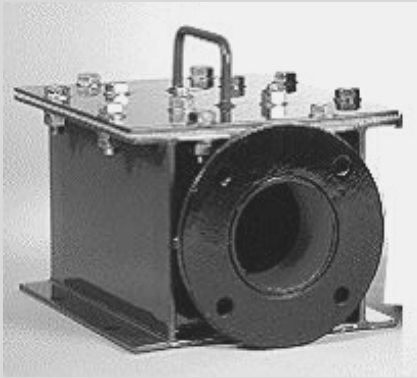

**Pneumatic Conveying**



# Technical Data Terminal Box

Pneumatic Bulk Solids Handling  
Document No. CPC-TDS-3140

## Physical Layout

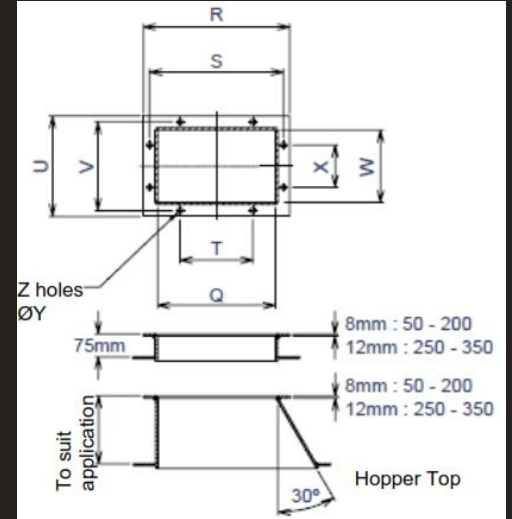
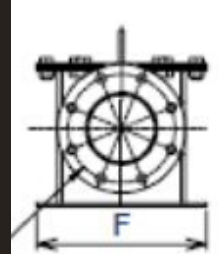
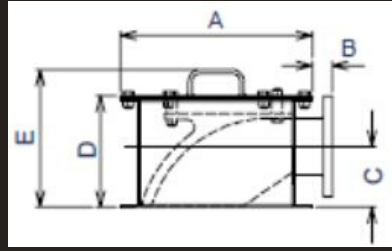

### Address

Clyde Pneumatic Conveying Ltd  
Lakeside Boulevard  
Lakeside  
Doncaster  
DN5 4PL  
United Kingdom

### Phone

+44 01302 552200

### Email

sales@clydepc.co.uk

### Web

www.clydepc.co.uk

## Main Dimensions

Dimensions - (mm)							
Size	A	B	C	D	E	F	KG
50	310	30	100	188	253	230	25
80	370	40	123	214	279	290	45
100	370	40	110	214	279	290	45
125	483	50	150	277	342	333	80
150	710	48	210	381	417	440	145
175	710	48	220	381	417	440	160
200	788	44	230	410	456	488	190
250	934	173	290	545	635	604	500
300	960	160	315	570	660	680	800
350	1104	198	350	629	719	754	950

Dimensions - (mm)										
SIZE	Q	R	S	T	U	V	W	X	ØY	Z
50	230	310	280	160	230	200	150	120	18	8
80	288	370	340	170	290	260	208	130	18	8
100	288	370	340	170	290	260	208	130	18	8
125	390	483	442	240	333	293	240	140	18	8
150	558	710	670	320	440	400	308	230	18	8
175	558	710	670	320	440	400	308	230	18	8
200	608	770	720	360	490	440	328	250	18	8
250	780	934	870	435	604	540	440	180	22	14
300	780	960	876	438	680	596	500	200	22	14
350	910	1100	1030	206	750	680	550	170	22	18

## Typical Installation



ISO9001 | ISO14001

British Engineering